

YMC precolumn filter

■ Product Structure

Stainless steel precolumn filter XRPRCS03

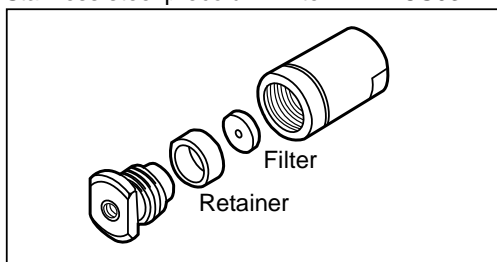

PEEK precolumn filter XRPRCP02

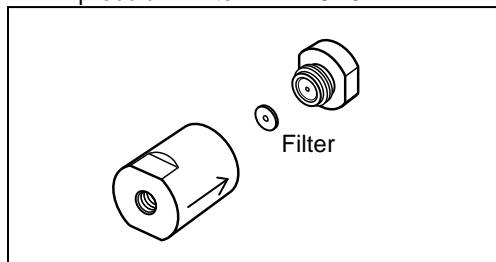

■ Specifications of Connection Parts

- The connection of the stainless steel precolumn filter is compatible with the Waters style.
- Connect the PEEK precolumn filter using PEEK tube and hand-tightened connectors.

■ How to Use

[Installation on the tubing]

- The screw specification of this unit is No.10-32UNF (for 1/16 inch tubing). To install the precolumn filter in front of a main column for the first time, a short piece of 1/16 inch tube (PEEK or stainless steel) and connectors (male nuts and ferrules) are required.
- Handy connector 2 (XRP0204), which is hand-tightened connector, is convenient to connect and disconnect the precolumn filter.
- It is recommended to measure the line pressure with the precolumn filter (but without a main column) at the beginning of use. The timing of the filter replacement can be judged by comparing the line pressure at the beginning of use and at a time when pressure increase is observed.
- The flow direction of the filter is not specified, so you can install it in either direction. However, flow direction should not be reversed when once used precolumn filter is reused. Or insoluble substances trapped in the filter may flow into the column and cause clogging. Arrow is marked on the holder part as a guide.
- After mounting, check that there is no leakage of fluid from the precolumn filter and the connection parts.

[Filter replacement]

- Remove the precolumn filter from the tubing, loosen the screw of the filter housing unit (use a spanner for a stainless steel precolumn filter), and remove the screw by hand keeping the filter housing unit vertical.
- The retainer, which is a part of a stainless steel pre-column filter, is an essential part for securing the filter. Insert the filter into the retainer before attaching it to the filter housing unit.
- Avoid over-tightening the PEEK precolumn filter. The screw thread may be damaged.

	Product number	Specification
For stainless steel precolumn filters	XRPRCS35	Replacement filter: 0.5 μ m, 5 pieces
For PEEK precolumn filters	XRPRCP25	Replacement filter: 2 μ m, 5 pieces

[Pressure limit]

- The pressure limit is about 60 MPa for the stainless steel precolumn filter, and about 35 MPa for the PEEK precolumn filter.
- The fluid leakage should be carefully watched around the pressure limit. Please use the product within the pressure limit to avoid any damage to the product.

YMC CO., LTD.

YMC Karasuma-Gojo Bldg., 284 Daigo-cho, Karasuma Nishiiru Gojo-dori, Shimogyo-ku,
Kyoto 600-8106, Japan
TEL +81-75-342-4515 FAX +81-75-342-4550
URL:www.ymc.co.jp E-Mail:sales@ymc.co.jp